

# Digitizing 8mm & Super 8 Film

## Equipment required:

- Your own USB Stick (8GB minimum recommended) or other digital storage device
- Wolverine MovieMaker Pro (USB Cable, Power Cable, red and grey reel adapters)
- Computer

## How do I know whether my film is 8mm or Super 8?

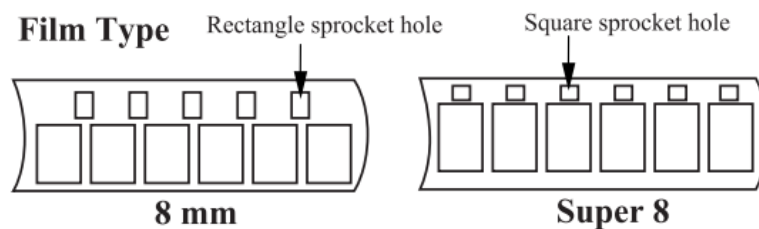

## How long does it take?

The MovieMaker Pro can digitize approximately 1-2 frames per second.

Reel Size	Run Time of Film	Conversion Time
3" (50 feet)	2-3 minutes	30 minutes
4" (100 feet)	5-6 minutes	1 hour
5" (200 feet)	12-14 minutes	2 hours

## Things to remember:

- **Do not** leave the MovieMaker Pro unattended while recording, in case the film gets jammed, coiled, or stops advancing and requires attention.
- Sound will not be transferred onto the digital file, only images
- The film will be saved as an MPEG-4 (MP4) file, converted at 1080p and at a slightly faster speed than original playback.
- Plugin the USB and power cables before beginning.

## Parts of the Wolverine MovieMaker Pro

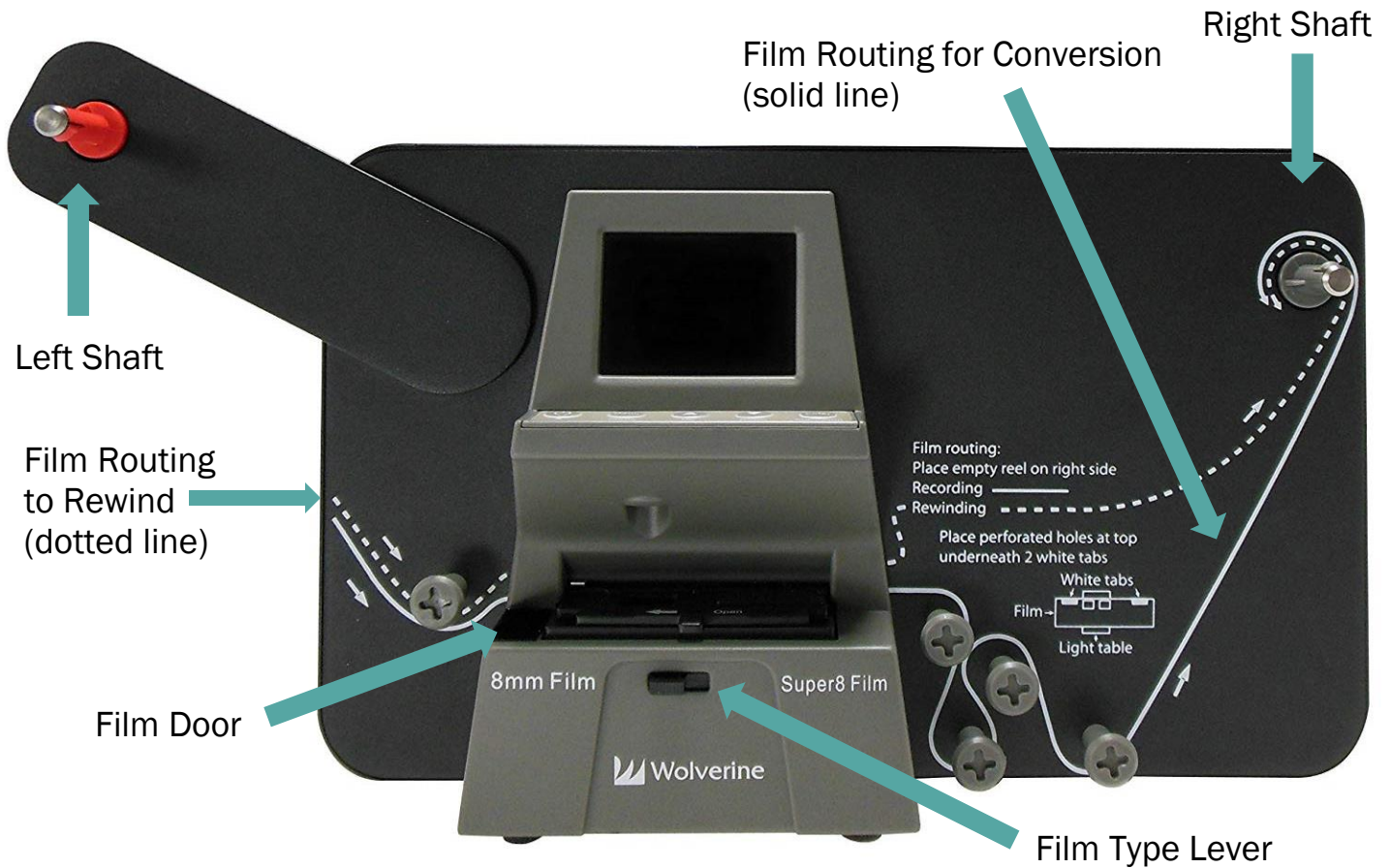

## Plug in the MovieMaker Pro

Plug the MovieMaker Pro into the power bar using the supplied power cable.

## Mount your reels and film

1. Ensure the arm of the MovieMaker Pro is in the up position.

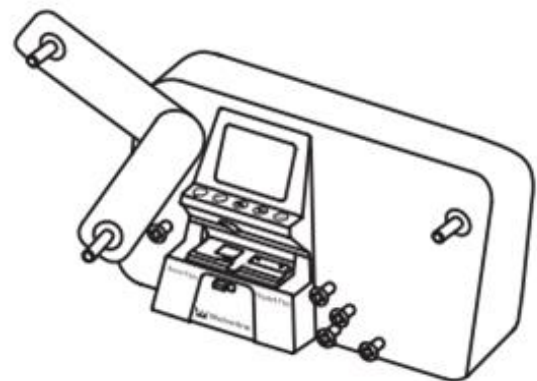

2. Place your film reel onto the left shaft, with the sprocket side closest to the machine. Push the reel onto the shaft until it clicks securely into place.

**Important:** If the sprocket's face the wrong direction the film may not feed correctly

If the reel on the left side shaft is loose/does not click, use the **red** reel adapter.

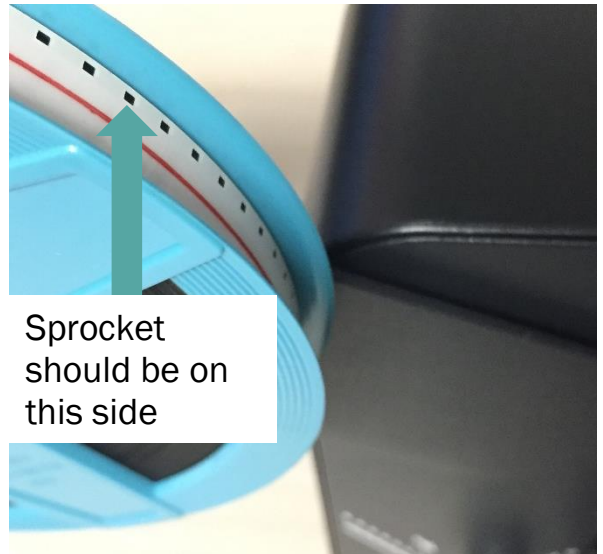
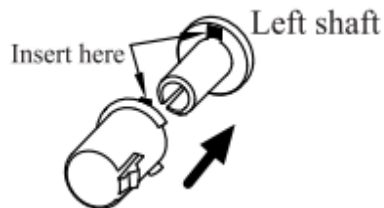

3. Place the empty reel on the right shaft.

4. Push the film door tab to the left to flip open the door. Don't worry about securing the film yet; you will do this in an upcoming step.

5. Route the film by following the film routing diagram (solid line) printed on the face of the MovieMaker Pro.

Note: Be sure to leave the film somewhat slack around the film routing pegs. If there is too much tension the film will not advance when the machine is started.

6. Place the end of the film in the notch marked *insert film here*.

Wind the empty reel, while making sure to leave enough slack to clip the film in over the light table. The film should be loose enough that the reel can still pull the film tight.



7. Position the first frame of the film to the left of the light table to ensure the beginning of the video is captured. The first frame will be where the black film starts and the white section ends.

8. Arrange the film over the light table:

1. Place and hold film underneath Tab #1
2. Twist film gently and clip under Tab #2
3. Twist film gently and clip under Tab #3
4. Press film door down to close

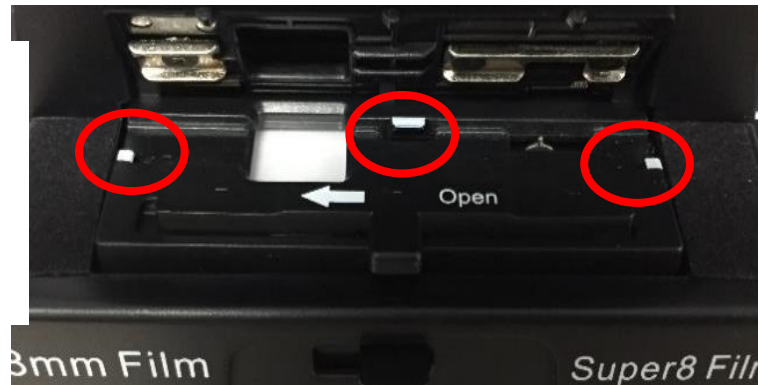

*Tabs circled in red*

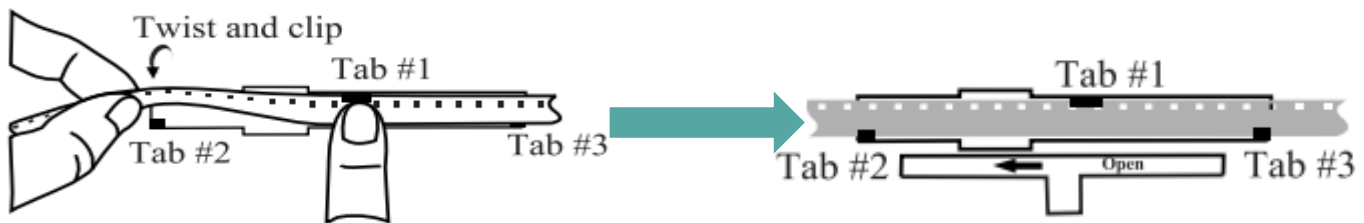

9. Slide the film type lever to the left for 8mm film, or to the right for Super 8 film.

## Beginning your recording

1. Press the power button to turn the MovieMaker Pro on.

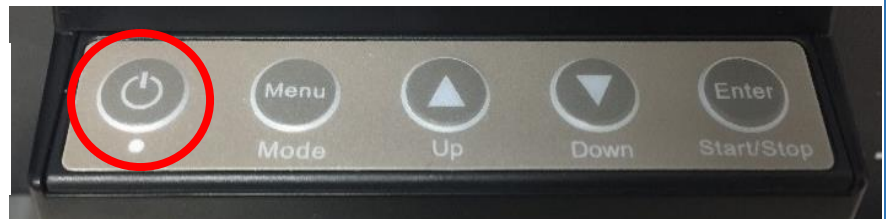

2. Press the Enter button to begin startup.

3. Press the Enter button again to start recording.

While recording is in progress, a red dot in the upper left corner of the screen will blink.

4. Press the Enter button to stop recording.

## Playback your recording

You can play back your recording on the screen built in to the MovieMaker Pro to check that the settings (such as framing) are correct.

1. Press the Menu button, highlight the Playback selection, then press Enter.
2. Press the Up/Down arrow button to select the file to be played back, then press Enter. Press Enter again to pause the playback.

Press the Menu button twice to go back to Record mode or the Main/Home menu.

## Adjusting the Frame

If the film is not centered in the frame, adjust the framing and start over.

Use the Up/Down keys to change the value of X, Y, W (see below for value meanings).

Press the menu button and then press the down arrow button until Frame ADJ is selected.

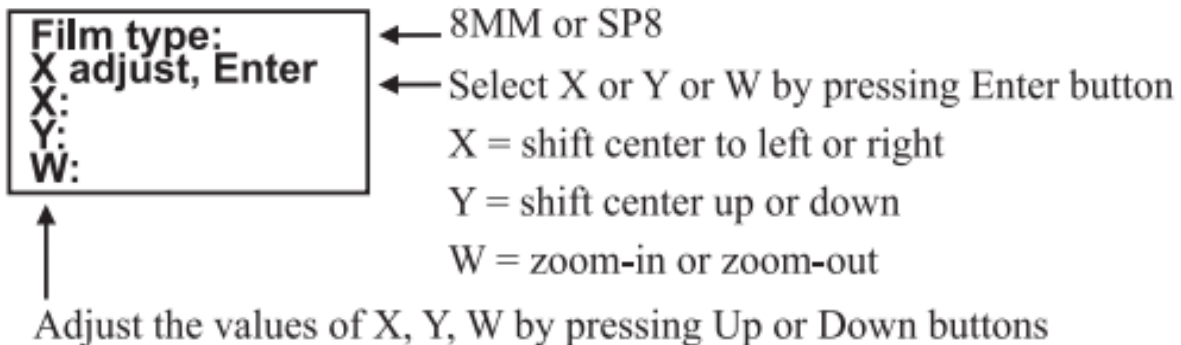

## Rewinding your film

1. Place your now empty reel on the right-side shaft; place the full reel on the left side shaft with the sprocket holes towards you. Push the reels onto the shafts until they click securely into place.

If the reel on the right-side shaft is loose/does not click, use the grey reel adapter.

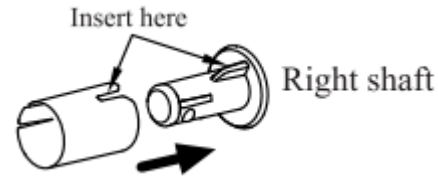

2. Follow the film rewind routing diagram printed on the face of the MovieMaker Pro (dotted line). Secure the film onto the empty reel by placing the end into a notch.

Note: **Do not** clip the film into the light table; let it run freely over it.

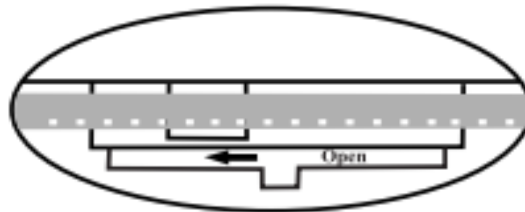

3. From the menu, select Rewind and use the Enter button to start/stop the rewinding process.

## Saving Your File

At the end of your session, **any files temporarily saved on the computer and the MovieMaker Pro will be deleted.** Please make sure you transfer all your files to your own storage device.

Once the recording stops:

1. Ensure the MovieMaker Pro is connected to the computer using the supplied USB cable.
2. Plug your USB key into the computer.
3. Press the Menu button on the MovieMaker Pro.
4. Scroll down using the down arrow button until you reach USB and press Enter

Click on the File Explorer folder icon in the Windows task bar:



The MovieMaker Pro will appear as USB Drive (F:). Select Drive (F:) then the folder called FilmScanner. In the FilmScanner folder open the folder labelled MOVIE:

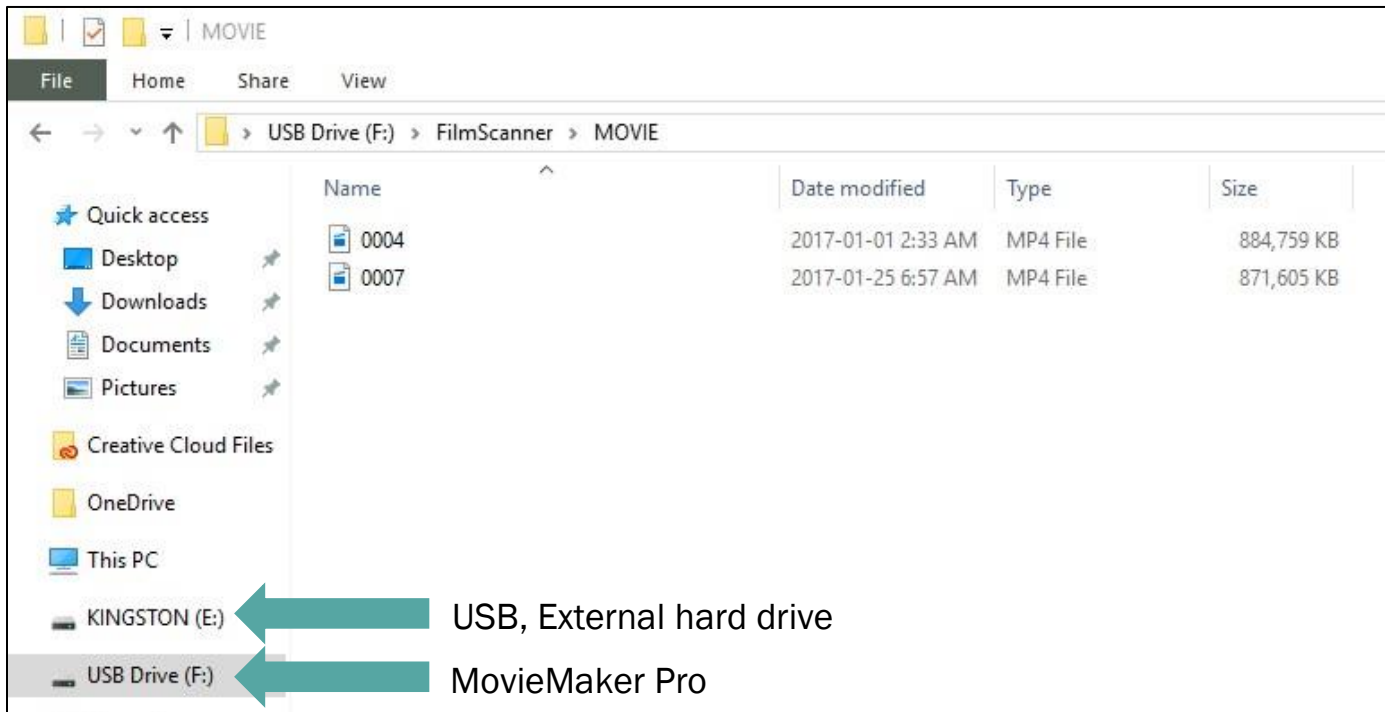

## 5. Copy your movie files from the MovieMaker Pro to your USB.

1. Right click on you file and select copy
2. Select the name of your USB/external drive (Kingston in the example above) and right click and select paste to add the files

## 6. Delete the movie files from the MovieMaker Pro.

1. Go back to the USB Drive (F:) and right click on the file
2. From the options list select delete

## At the end of your session:

- Close all the windows on the computer.
- Power off the Wolverine MovieMaker Pro by holding down the power button until the display reads *Bye*.
- Be sure to take your USB/external drive and 8mm/Super 8 film with you when you leave.
- Let the librarian at the info desk know you are done